

KONFLIKT '47[®]



US M2A5 LINEBACKER JUMP WALKER

ASSEMBLY GUIDE



The Linebacker jump walker drops into the thick of the action!

This mobile, powerful walker packs a heavy punch, and can be equipped with a wide assortment of weaponry, allowing it to take on any challenge.

ASSEMBLY GUIDE KEY



Assembly stage



Do not glue

22

Part number



Previous assembly stage



Special assembly instructions



Optional assembly



Drill part

Follow this simple guide to build your M2A5 Linebacker Jump Walker.

Carefully remove each component from the frame with clippers or a craft knife. Trim off excess plastic before assembling. Test fit all components before applying glue.

We recommend using plastic glue to assemble the kit. Please follow all usage and safety advice given on the product.

Keep tools, glues, paints, and small components away from children. Warlord Games recommends this kit for ages 14 and over.

DECAL APPLICATION GUIDE

- Apply a coat of gloss varnish to the areas that will receive the decal and allow this to dry fully.
- Cut out a decal from the sheet and soak it in lukewarm water for 1-2 minutes.
- Once the design has started to separate from the backing paper, use tweezers or a wet paintbrush to slide the design into place on the model.
- Use a tissue to dab away any excess water from the model and allow to dry.
- Apply a coat of matt varnish to seal the decal in place.

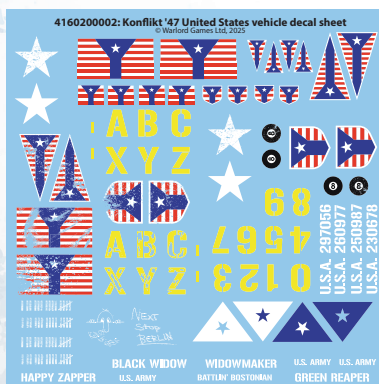

KONELIG 47: LINEBACKER 1

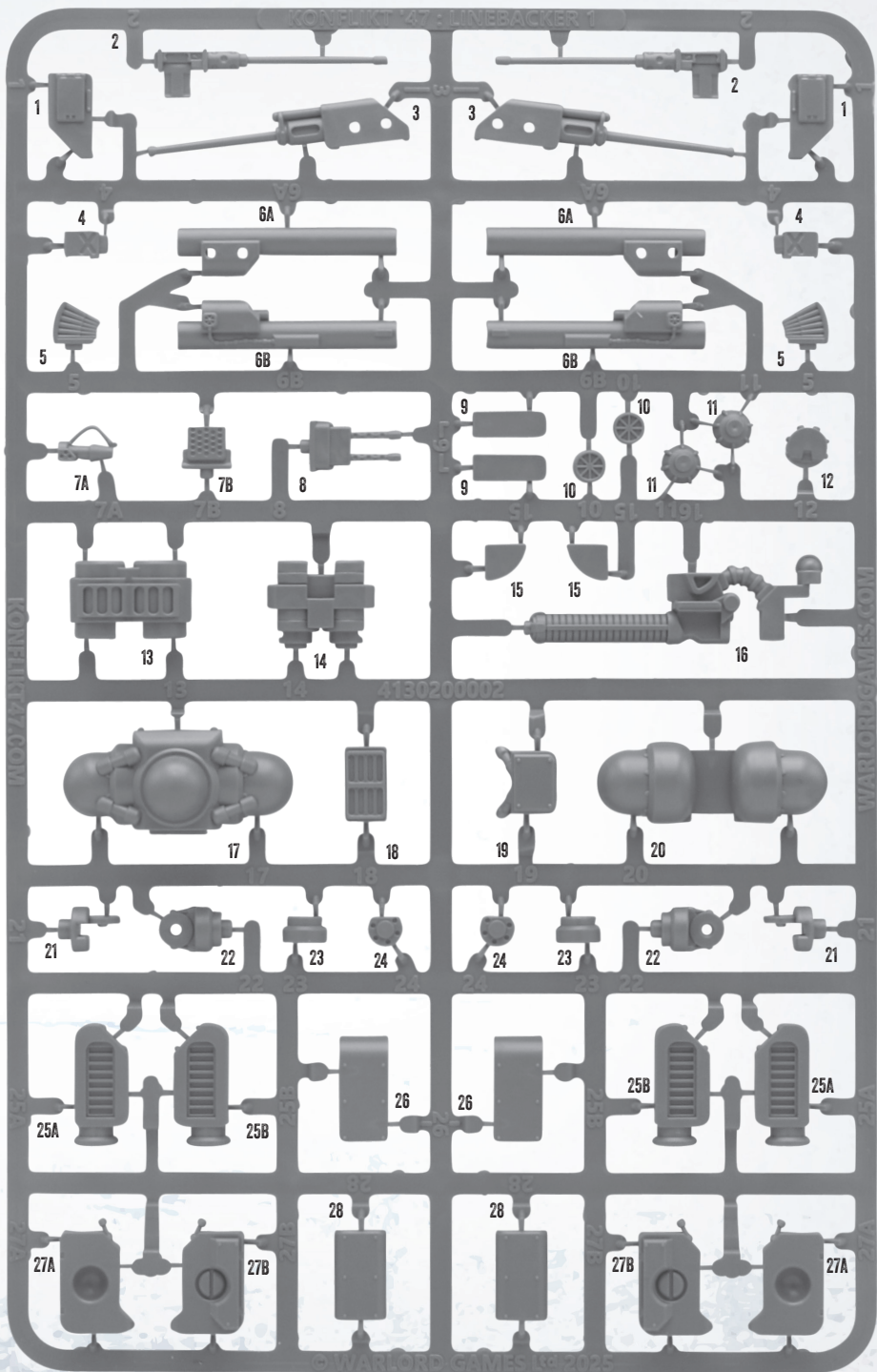

- 1
- 2
- 3
- 4
- 5
- 6A
- 6B
- 7A
- 7B
- 8
- 9
- 10
- 11
- 12
- 13
- 14
- 15
- 16
- 17
- 18
- 19
- 20
- 21
- 22
- 23
- 24
- 25A
- 25B
- 26
- 27A
- 27B
- 28

KONFLIKT '47 : LINEBACKER 1

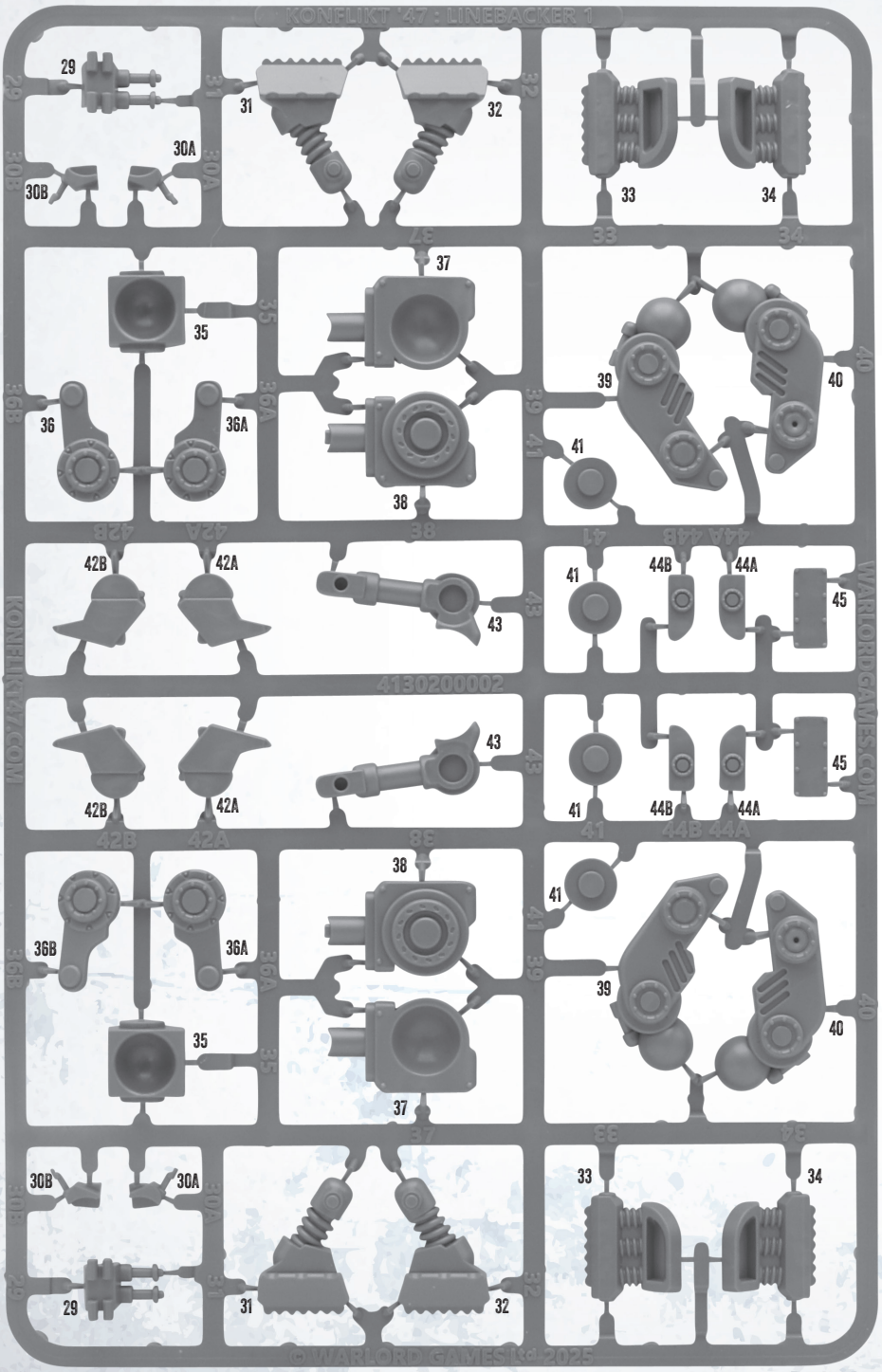

4130200002

KONFLIKT 47 : LINEBACKER 2

4130200003

WARRIORGAMES.COM

© WARRIOR GAMES LTD 2025

91

1

2

3

4

5

6

7

8

9

10

11

15

14

16

14

13

12

18

18

19

20

21

22

4

5

6

7

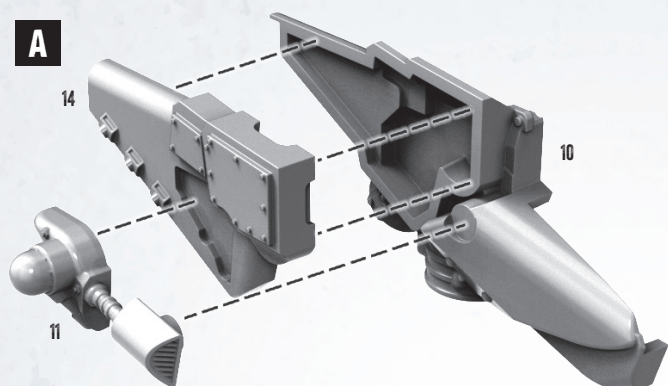
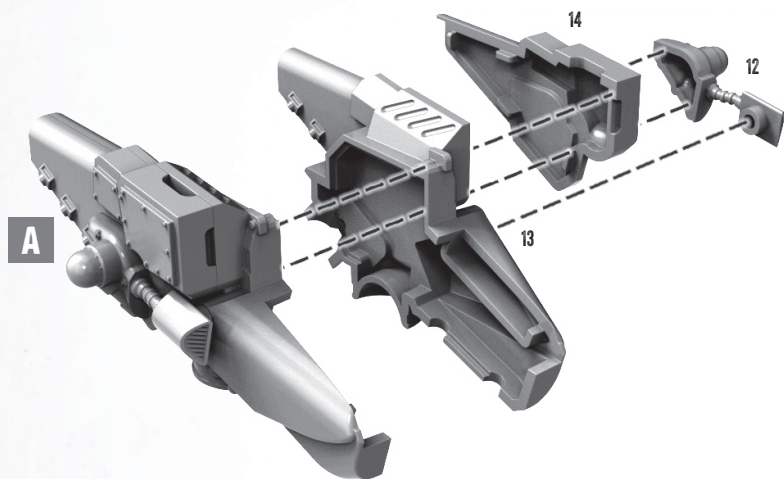
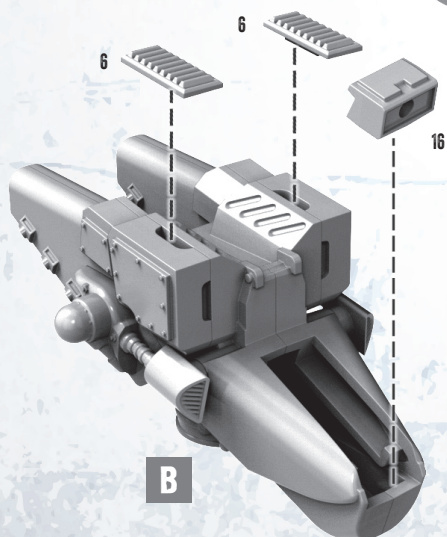
A**B****C**

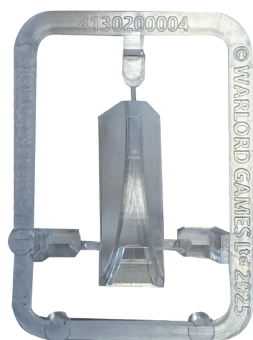
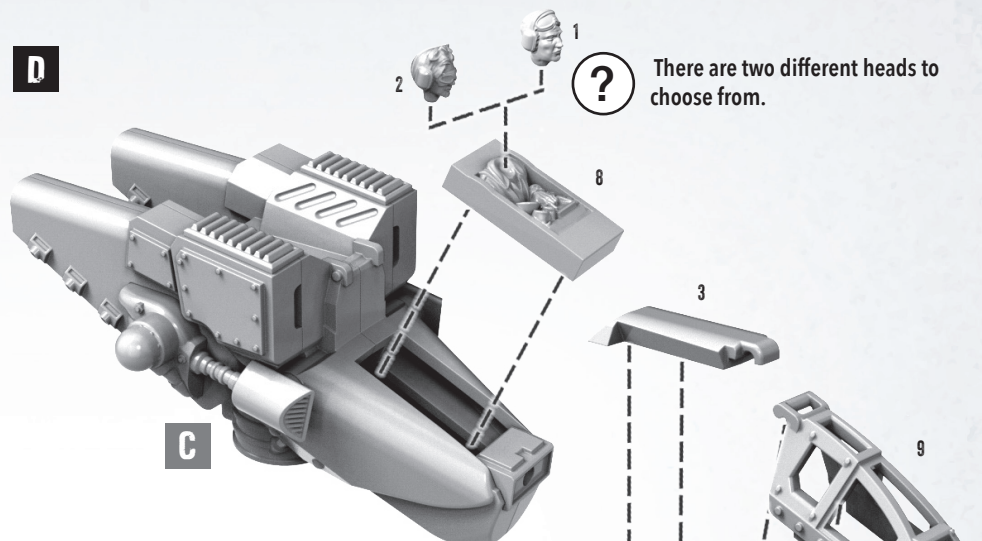
D

Clear canopy sprue.

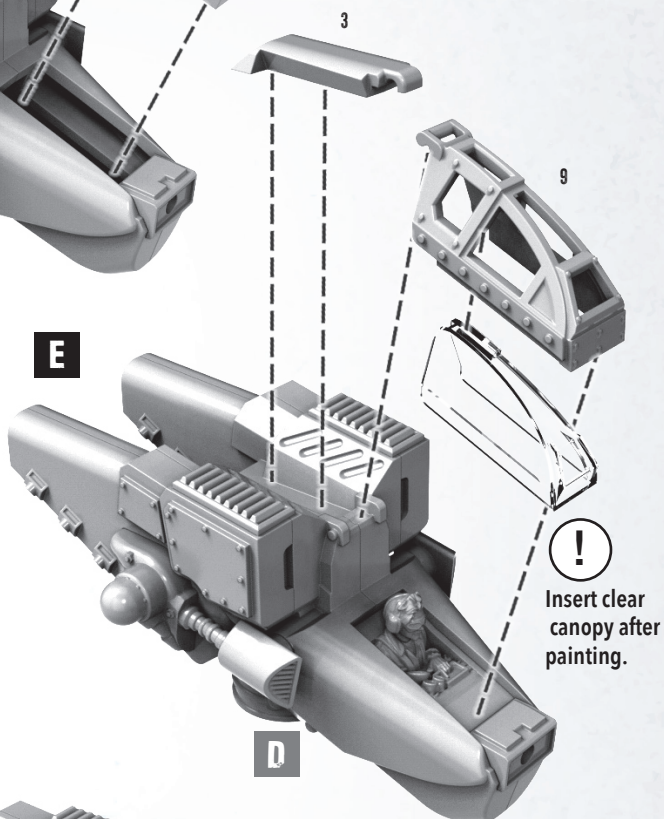
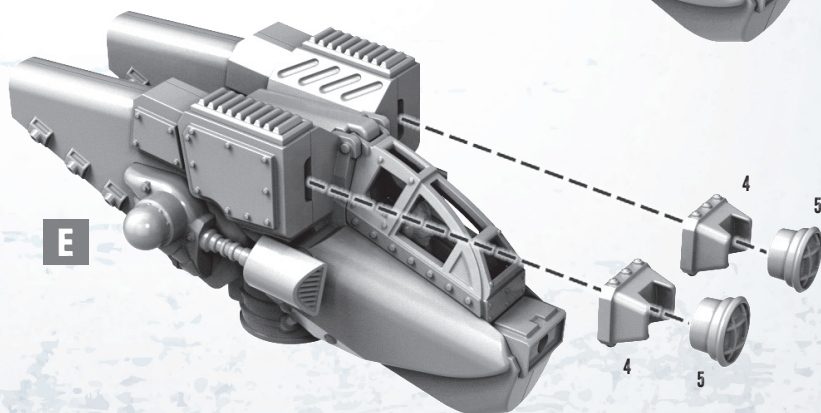
E**D****F****E**

G

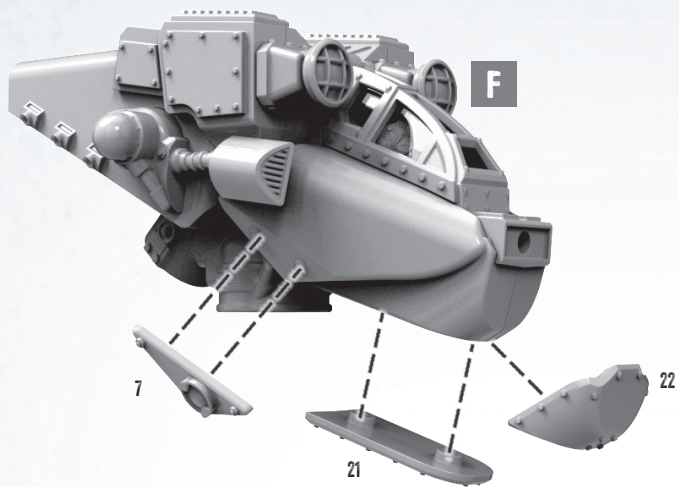

H

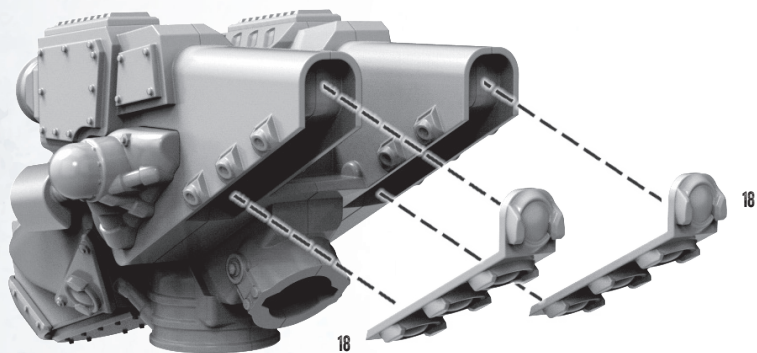

G

I

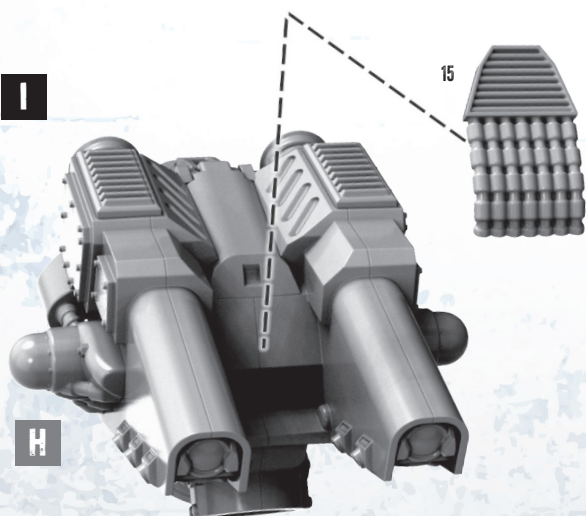

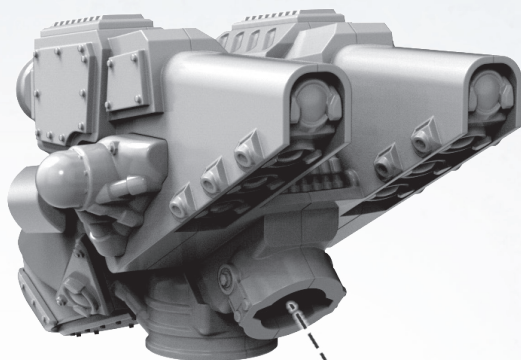
J**I**

20

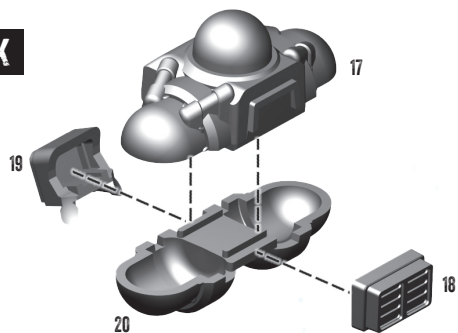

19

K

17

19

20

18

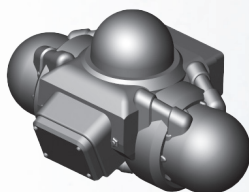
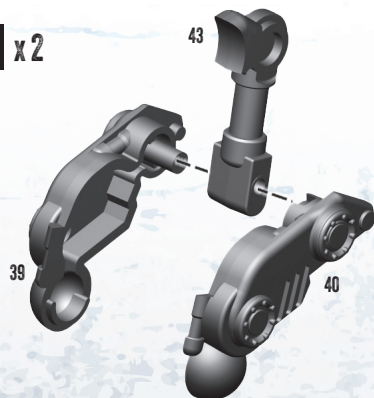
K**L** x 2

43

39

40

L

Repeat stages L-W for both
the left and right legs

M x2

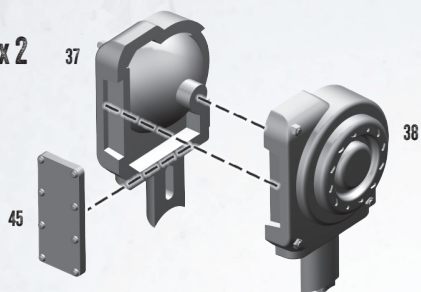

N1 x2

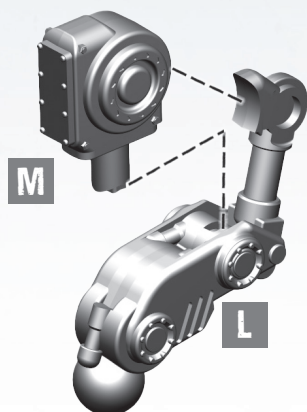

N2 x2

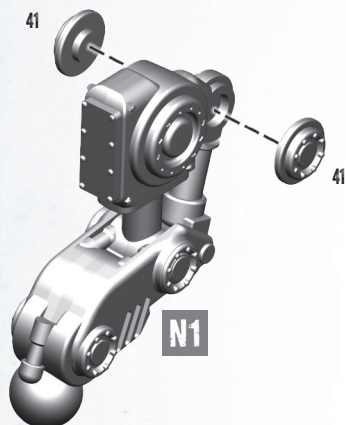

N2

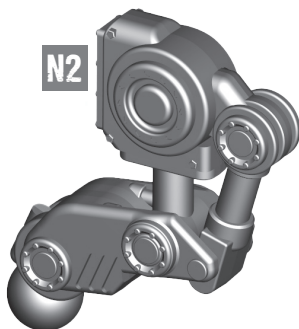

O x2

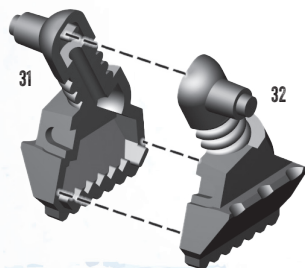

P x2

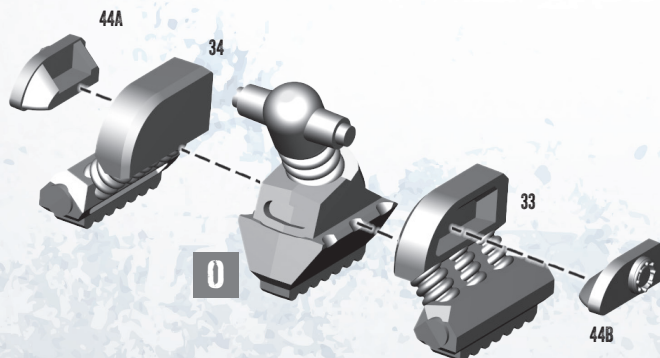

Q x2

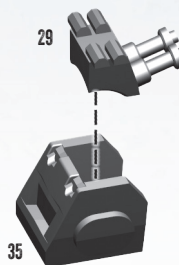

Q

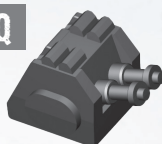

R x2

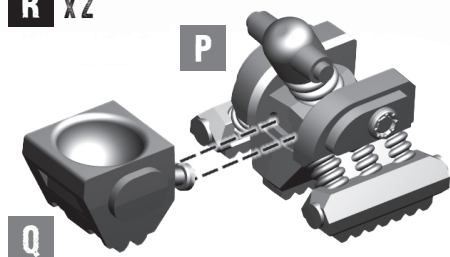

S

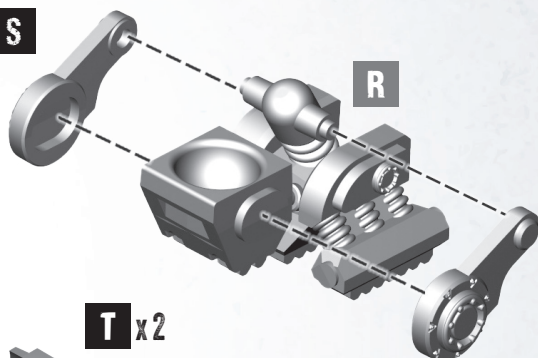

T x2

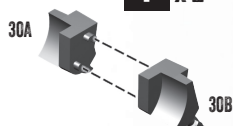

U x2

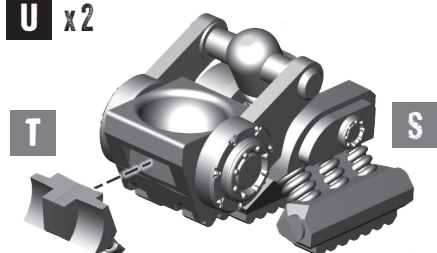

W x2



V x2

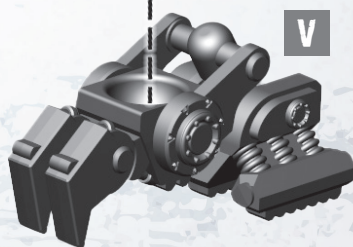
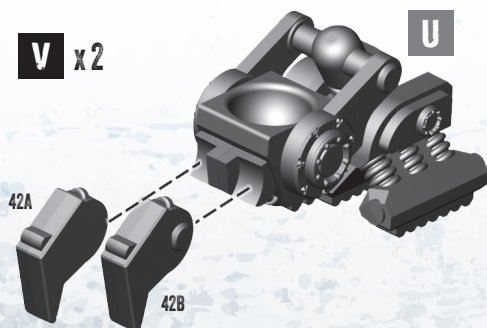

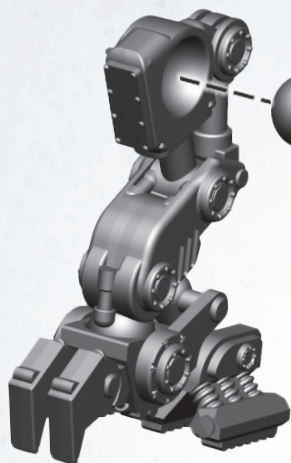
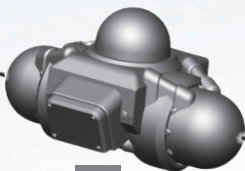
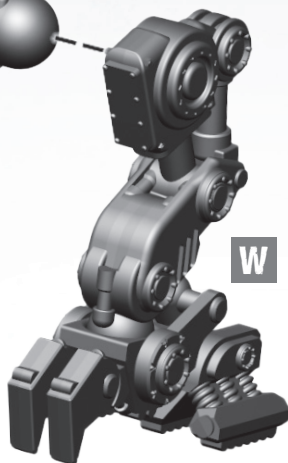
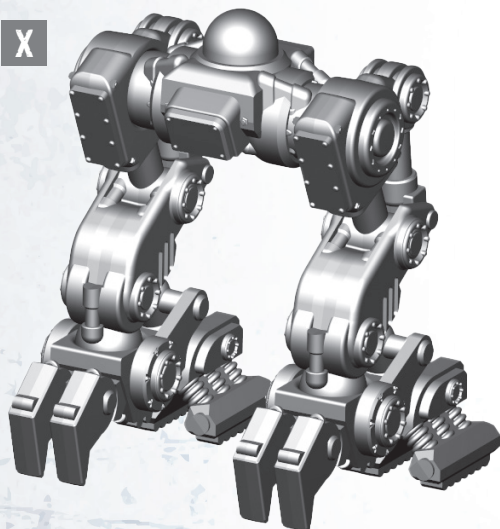
X**K****W****X****Y****x2**

Repeat stages Y-Z5 for both the left and right arms

27A

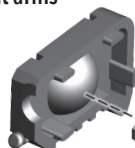

27B

**Z****x2**

22

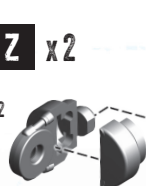

23

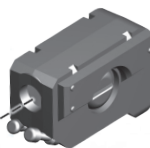
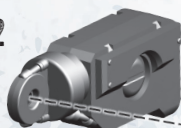
Y**Z1** **x2****Z**

21

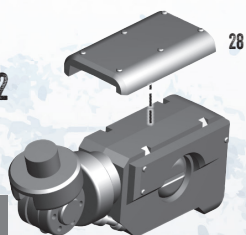

24

**Z2****x2****Z1**

28

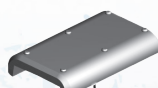

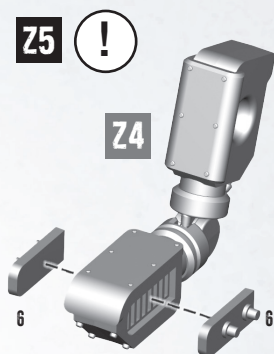
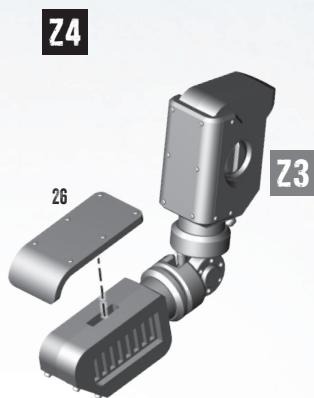
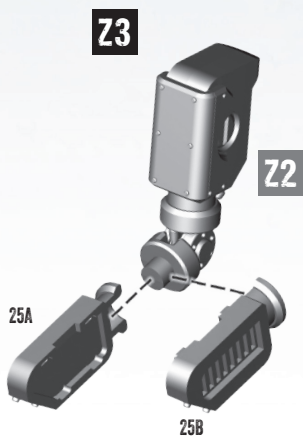

Apply this stage for Autocannons,
Super-Bazookas, or HMG's only.

Construction option for the Autocannon.

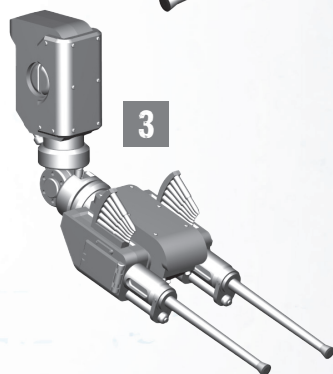
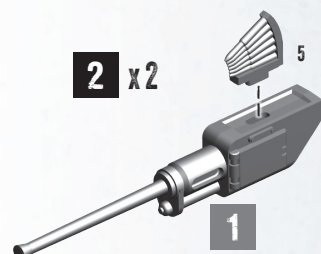
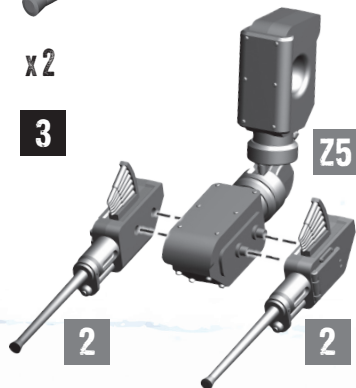
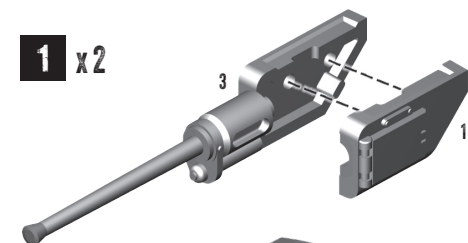

Construction option for the Super Bazooka.

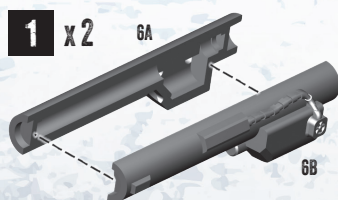

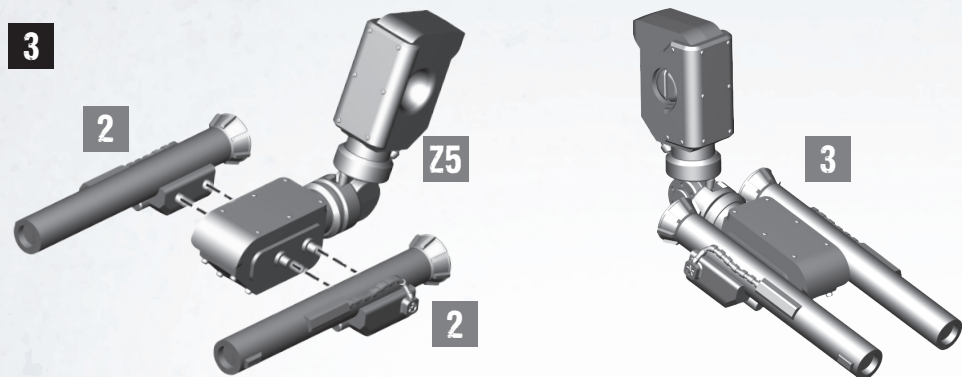

Construction option for the HMG.

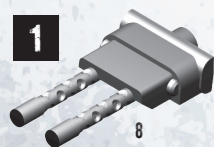
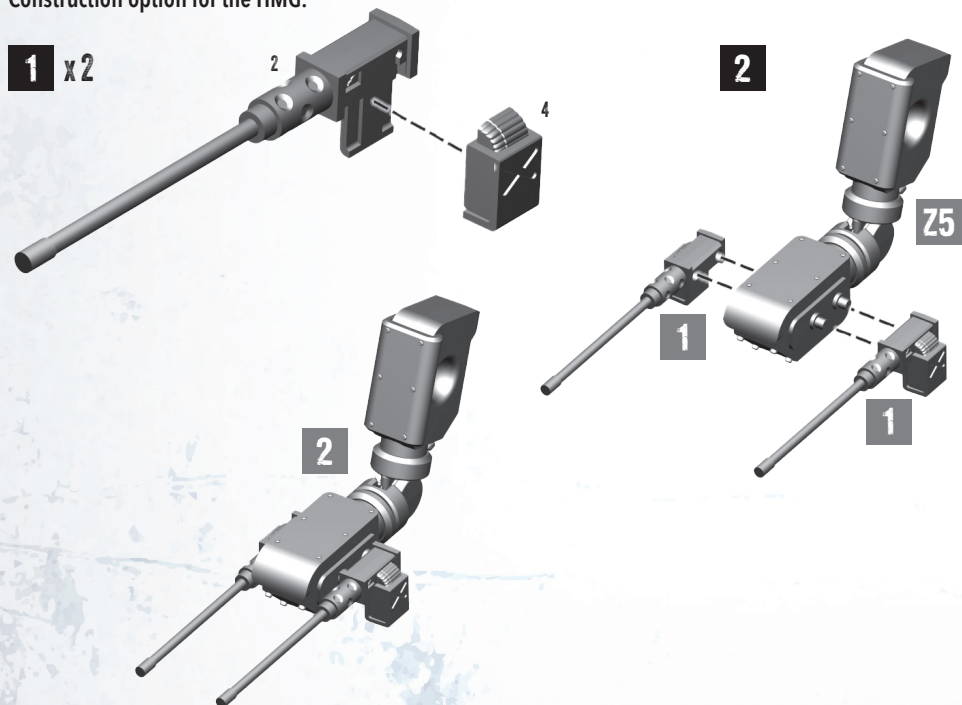

Chin-mounted option for the MMG.

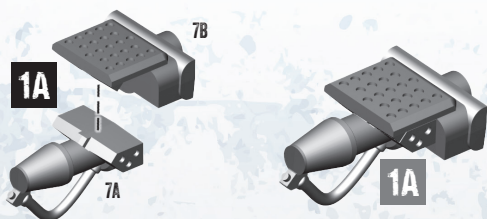

Chin-mounted option for the Flamethrower.

Construction option for the Light Tesla Cannon.

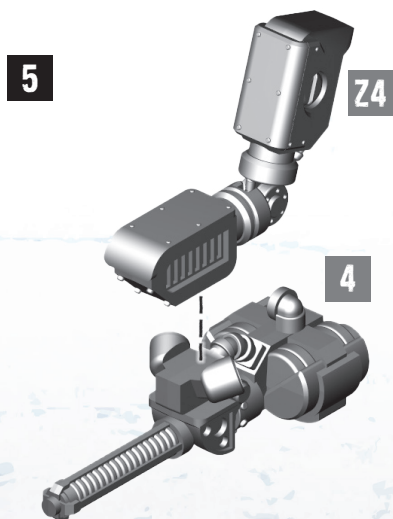
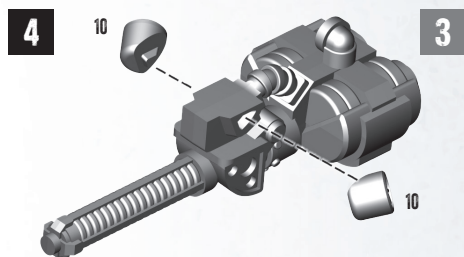
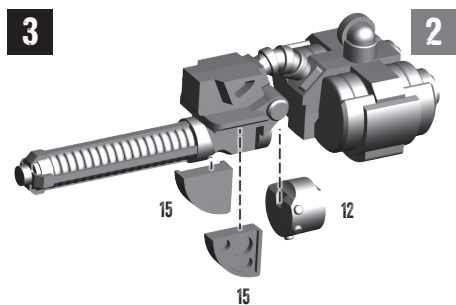
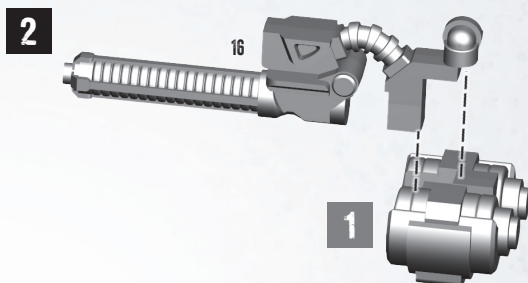
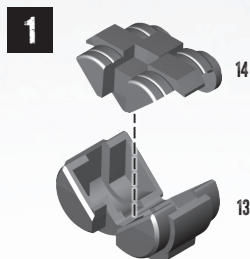

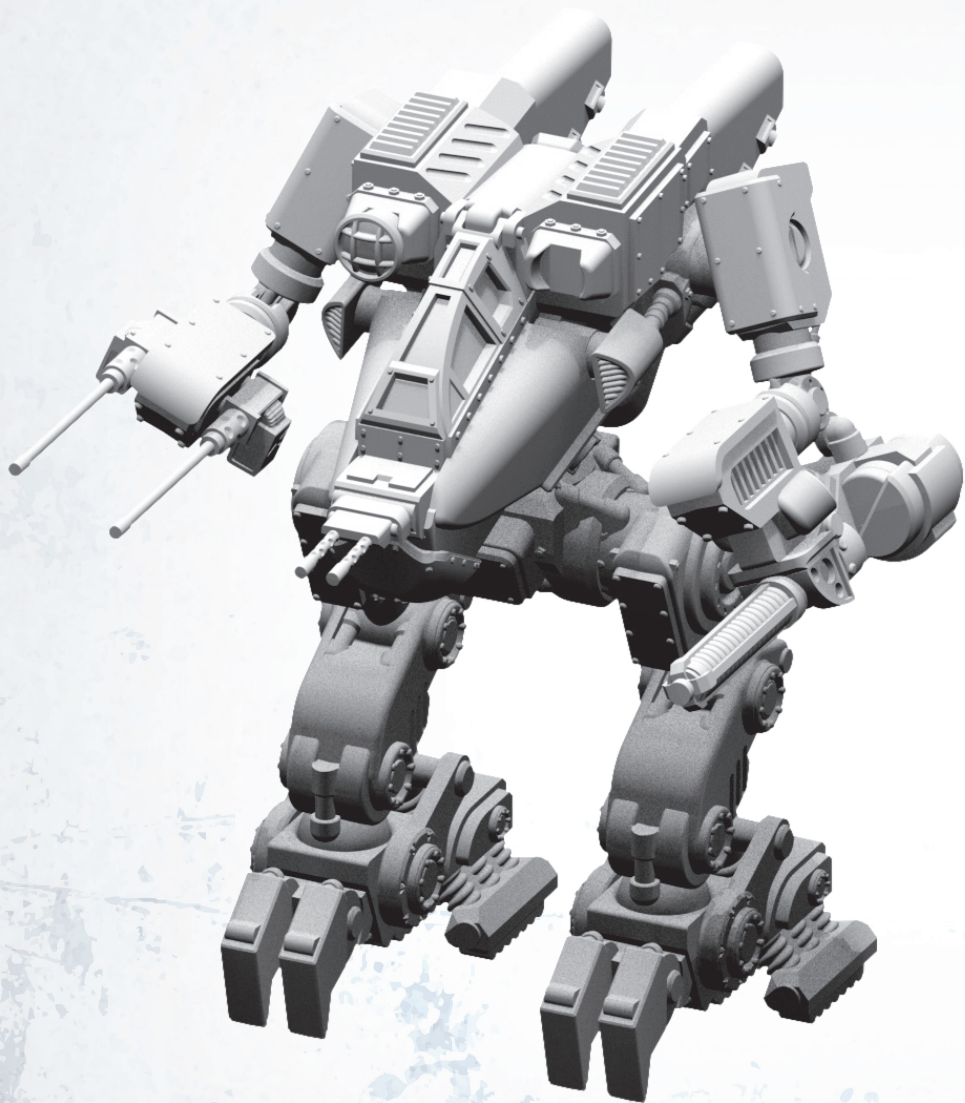

M2A5 Linebacker with Light Tesla Cannon and Heavy Machine Guns.

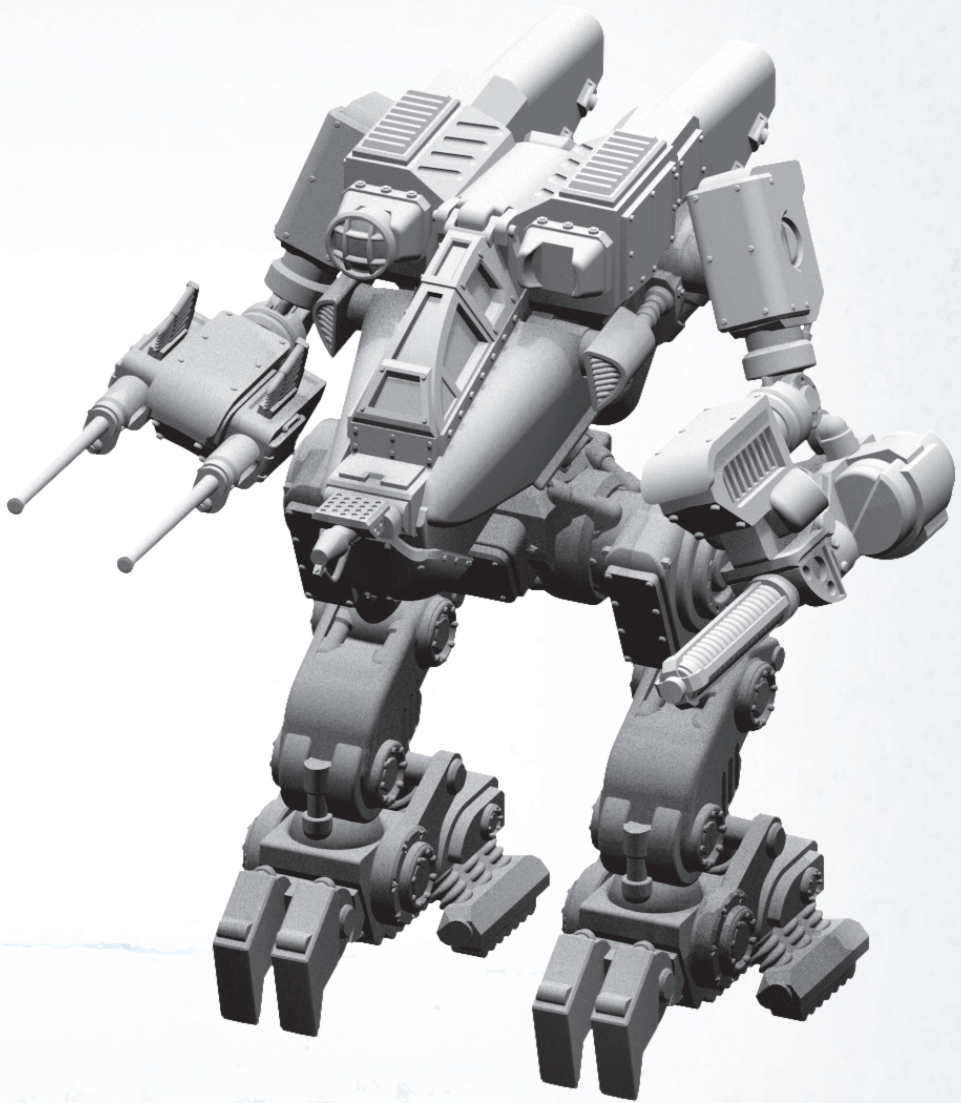

M2A5 Linebacker with Light Tesla Cannon and Autocannons.



M2A5 Linebacker with Light Tesla Cannon and Super Bazookas.



Chin-mounted Medium Machine Guns.



Chin-mounted Flamethrower.





**THIS IS NOT WAR.
THIS IS THE END.**

Copyright Warlord Games Ltd. 2025

Component code: **4170200003**